

Jaws ZG-ZS

Tool group A09
Type 300 **Inside jaw BB DIN 6350**
outward stepped jaw, hardened



Item no.	Chuck Size	Number of jaws	Jaw length	Jaw height	Jaw width
110154 ¹⁾ ●	74	3	32	23	10
110155 ●	80/85	3	37	26	12
110156 ●	100/110	3	48	33,5	14
110157 ●	125	3	52	41,5	18
110158 ●	140	3	61	41,5	18
110159 ●	160	3	61	47,5	18
110160 ●	200	3	69	53,5	20
110161 ●	250	3	90	67,5	24
110162 ●	315	3	130	79,5	34
110163 ●	350/400	3	130	79,5	34
110164 ▲	500/630	3	190	95	42

¹⁾ reversible, for use as turning or inside jaws

Stepped and hardened jaws, supplied as supplement or as spares, must be ground on the chuck.
In case of a subsequent jaw delivery please return the chuck.

Tool group A09
Type 400 **Inside jaw BB DIN 6350**
outward stepped jaw, hardened



Item no.	Chuck Size	Number of jaws	Jaw length	Jaw height	Jaw width
110063 ▲	80/85	4	37	26	12
110064 ▲	100/110	4	48	33,5	14
110065 ●	125	4	52	41,5	18
110066 ▲	140	4	61	41,5	18
110067 ●	160	4	61	47,5	18
110068 ●	200	4	69	53,5	20
110069 ●	250	4	90	67,5	24
110070 ●	315	4	130	79,5	34
110071 ▲	350/400	4	130	79,5	34
110072 ▲	500/630	4	190	95	42

¹⁾ jaws reversible

Stepped and hardened jaws, supplied as supplement or as spares, must be ground on the chuck.
In case of a subsequent jaw delivery please return the chuck.

Tool group A09
Type 300 **Outside jaw DB DIN 6350**
inward stepped jaw, hardened



Item no.	Chuck Size	Number of jaws	Jaw length	Jaw height	Jaw width
110165 ●	80/85	3	37	26	12
110166 ●	100/110	3	48	33,5	14
110167 ●	125	3	52	41,5	18
110168 ●	140	3	61	41,5	18
110169 ●	160	3	61	47,5	18
110170 ●	200	3	69	53,5	20
110171 ●	250	3	90	67,5	24
110016 ●	315	3	130	79,5	34
110017 ●	350/400	3	130	79,5	34
110018 ▲	500/630	3	190	95	42

Stepped and hardened jaws, supplied as supplement or as spares, must be ground on the chuck.
In case of a subsequent jaw delivery please return the chuck.

Tool group A09
Type 400 **Outside jaw DB DIN 6350**
inward stepped jaw, hardened



Item no.	Chuck Size	Number of jaws	Jaw length	Jaw height	Jaw width
110073 ▲	80/85/80/85	4	37	26	12
110074 ▲	100/110	4	48	33,5	14
110075 ●	125	4	52	41,5	18
110076 ▲	140	4	61	41,5	18
110077 ●	160	4	61	47,5	18
110078 ●	200	4	69	53,5	20
110079 ●	250	4	90	67,5	24
110080 ▲	315	4	130	79,5	34
110081 ▲	350/400	4	130	79,5	34
110082 ▲	500/630	4	190	95	42

Stepped and hardened jaws, supplied as supplement or as spares, must be ground on the chuck.
In case of a subsequent jaw delivery please return the chuck.

Jaws ZG-ZS

Tool group A09
Type 301 **Unstepped jaw BL**
DIN 6350
unstepped, soft, 16MnCr5



Item no.	Chuck Size	Number of jaws	Jaw length	Jaw height	Jaw width
109114 ¹⁾ ●	74	3	32	23	10
107588 ●	80/85	3	37	26	12
107589 ●	100/110	3	48	33,5	14
107590 ●	125	3	52	41,5	18
107591 ●	140	3	61	41,5	18
107592 ●	160	3	61	47,5	18
107593 ●	200	3	69	53,5	20
107594 ●	250	3	90	67,5	24
107595 ●	315	3	130	79,5	34
107596 ●	350/400	3	130	79,5	34
107597 ●	500/630	3	190	95	42

¹⁾ jaws reversible

Tool group A09
Type 401 **Unstepped jaw BL**
DIN 6350
unstepped, soft, 16MnCr5



Item no.	Chuck Size	Number of jaws	Jaw length	Jaw height	Jaw width
107598 ●	80/85	4	37	26	12
107599 ●	100/110	4	48	33,5	14
107600 ●	125	4	52	41,5	18
107601 ●	140	4	61	41,5	18
107602 ●	160	4	61	47,5	18
107603 ●	200	4	69	53,5	20
107604 ●	250	4	90	67,5	24
107605 ●	315	4	130	79,5	34
107644 ●	350/400	4	130	79,5	34
107645 ▲	500/630	4	190	95	42

¹⁾ jaws reversible

Tool group A09
Type 302 **Base jaw GB** **DIN 6350**
with fixing screw



Item no.	Chuck Size	Number of jaws	Jaw length	Jaw width
107500 ●	100/110	3	46	14
107501 ●	125	3	55	18
107502 ●	140	3	65	18
107503 ●	160	3	65	18
107504 ●	200	3	78	20
107505 ●	250	3	92	24
107506 ●	315	3	108	34
107507 ●	350/400	3	127	34
107508 ●	500	3	165	42
107509 ●	630	3	203	42

Tool group A09
Type 402 **Base jaw GB** **DIN 6350**
with fixing screw



Item no.	Chuck Size	Number of jaws	Jaw length	Jaw width
107542 ●	100/110	4	46	14
107543 ●	125	4	55	18
107544 ▲	140	4	65	18
107545 ●	160	4	65	18
107546 ●	200	4	78	20
107547 ●	250	4	92	24
107548 ●	315	4	108	34
107549 ▲	350/400	4	127	34
107550 ▲	500	4	165	42
107551 ▲	630	4	203	42

Jaws ZG-ZS

Tool group A09
Type 303 **Reversible top jaws UB**
DIN 6350
hardened



Item no.	Chuck Size	Number of jaws	Jaw length	Jaw height	Jaw width
108045 ■	100/110	3	47	29,5	22
108046 ■	125	3	56	37,5	26
107936 ●	140/160	3	66,7	41,5	28
107937 ●	200	3	79,5	42,5	30
108049 ●	250	3	95,3	52,5	36
108050 ●	315	3	109,5	57,5	42
108051 ●	350/400	3	127	64,5	42
108052 ■	500/630	3	127	79,5	50

Stepped and hardened jaws, supplied as supplement or as spares, must be ground on the chuck.
In case of a subsequent jaw delivery please return the chuck.

Tool group A09
Type 403 **Reversible top jaws UB**
DIN 6350
hardened



Item no.	Chuck Size	Number of jaws	Jaw length	Jaw height	Jaw width
108053 ■	100/110	4	47	29,5	22
108054 ■	125	4	56	37,5	26
107938 ■	140/160	4	66,7	41,5	28
107939 ■	200	4	79,5	42,5	30
108057 ■	250	4	95,3	52,5	36
108058 ■	315	4	109,5	57,5	42
108059 ■	350/400	4	127	64,5	42
108060 ■	500/630	4	127	79,5	50

Stepped and hardened jaws, supplied as supplement or as spares, must be ground on the chuck.
In case of a subsequent jaw delivery please return the chuck.

Tool group A09
Type 302 **Unstepped top jaw AB**
DIN 6350
soft, material 16MnCr5



Item no.	Chuck Size	Number of jaws	Jaw length	Jaw height	Jaw width
107633 ●	100/110	3	53	30	22,5
107634 ●	125	3	62	38	26,5
108581 ●	140/160	3	74	42	28,5
108582 ●	200	3	87	43	30,5
107637 ●	250	3	103	53	36,5
107638 ●	315	3	120	58	42,5
107639 ●	350/400	3	137	65	42,5
107640 ●	500/630	3	140	80	50,5

Tool group A09
Type 402 **Unstepped top jaw AB**
DIN 6350
soft, material 16MnCr5



Item no.	Chuck Size	Number of jaws	Jaw length	Jaw height	Jaw width
107641 ■	100/110	4	53	30	22,5
107642 ●	125	4	62	38	26,5
108583 ●	140/160	4	74	42	28,5
108584 ●	200	4	87	43	30,5
107579 ●	250	4	103	53	36,5
107580 ●	315	4	120	58	42,5
107581 ●	350/400	4	137	65	42,5
107582 ●	500/630	4	140	80	50,5

Jaws ZG-ZS

Tool group A09
Type 301 **Unstepped jaw BL**,
special length, soft, 16MnCr5
DIN 6350



Item no.	Chuck Size	Number of jaws	A1	X1 max.	A	J	X Max.
130031	200	3	100	50	69	32,5	19
132658	250	3	120	56	90	41	26
132184	315	3	160	70	130	46	40
137075	350/400	3	160	70	130	42	40
131540	500/630	3	220	80	190	55	50
130033	200	3	120	70	69	32,5	19
128880	250	3	140	76	90	41	26
118908	315	3	200	110	130	46	40
137079	350/400	3	200	110	130	42	40
137081	500/630	3	280	140	190	55	50
121367	315	3	250	160	130	46	40
137087	350/400	3	250	160	130	42	40

Tool group A09
Type 401 **Unstepped jaw BL**,
special length, soft, 16MnCr5
DIN 6350

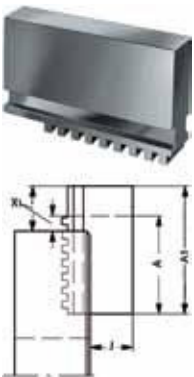

Item no.	Chuck Size	Number of jaws	A1	X1 max.	A	J	X Max.
137073	200	4	100	50	69	32,5	19
137074	250	4	120	56	90	41	26
129894	315	4	160	70	130	46	40
130442	350/400	4	160	70	130	42	40
137076	500/630	4	220	80	190	55	50
137077	200	4	120	70	69	32,5	19
130610	250	4	140	76	90	41	26
137078	315	4	200	110	130	46	40
137080	350/400	4	200	110	130	42	40
137082	500/630	4	280	140	190	55	50
133691	315	4	250	160	130	46	40
137088	350/400	4	250	160	130	42	40

Tool group A09
Type 301 **Unstepped jaw BL**,
special height, soft, 16MnCr5
DIN 6350



Item no.	Chuck Size	Number of jaws	C1	J1	C	J
125710	200	3	80	58,5	54	32,5
122188	250	3	100	73	68	41
132186	315	3	110	76	80	46
137092	350/400	3	110	72	80	42
137093	500/630	3	150	110	95	55
125712	200	3	120	98,5	54	32,5
122189	250	3	130	103	68	41
137096	315	3	140	106	80	46
137098	350/400	3	140	102	80	42
125117	500/630	3	200	160	95	55
125714	200	3	150	128,5	54	32,5
137102	250	3	150	123	68	41
137104	315	3	160	126	80	46
132879	350/400	3	160	122	80	42

Jaws ZG-ZS

Tool group A09
Type 401 **Unstepped jaw BL**,
special height, soft, 16MnCr5
DIN 6350



Item no.	Chuck Size	Number of jaws	C1	J1	C	J
132972	200	4	80	58,5	54	32,5
134796	250	4	100	73	68	41
137091	315	4	110	76	80	46
131655	350/400	4	110	72	80	42
137094	500/630	4	150	110	95	55
137095	200	4	120	98,5	54	32,5
130630	250	4	130	103	68	41
137097	315	4	140	106	80	46
137099	350/400	4	140	102	80	42
137100	500/630	4	200	160	95	55
137101	200	4	150	128,5	54	32,5
137103	250	4	150	123	68	41
130340	315	4	160	126	80	46
110109	350/400	4	160	122	80	42

Tool group A09
Type 302 **Top jaw AB**,
special length, soft, 16MnCr5
DIN 6350

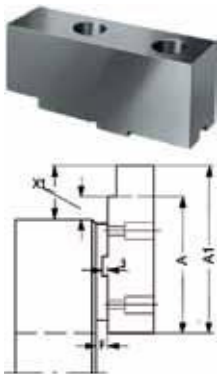

Item no.	Chuck Size	Number of jaws	A1	X1 max.	F	A	X Max.
110086	200	3	100	43	6,8	87	30
112122	250	3	130	63	8	103	36
110624	315	3	160	76	5,5	120	36
110626	350/400	3	160	53	8,5	137	30
103014	500/630	3	170	75	8,5	140	45
112120	200	3	120	63	6,8	87	30
125428	250	3	150	83	8	103	36
112091	315	3	200	116	5,5	120	36
112118	350/400	3	200	93	8,5	137	30
110632	500/630	3	220	125	8,5	140	45
104710	250	3	180	113	8	103	36
112089	315	3	250	166	5,5	120	36
103654	350/400	3	260	153	8,5	137	30
112127	500/630	3	280	185	8,5	140	45

Tool group A09
Type 402 **Top jaw AB**,
special length, soft, 16MnCr5
DIN 6350

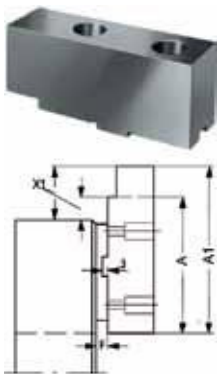

Item no.	Chuck Size	Number of jaws	A1	X1 max.	F	A	X Max.
148139	200	4	100	43	6,8	87	30
129289	250	4	130	63	8	103	36
143764	315	4	160	76	5,5	120	36
141277	350/400	4	160	53	8,5	137	30
103393	500/630	4	170	75	8,5	140	45
148657	200	4	120	63	6,8	87	30
128700	250	4	150	83	8	103	36
147754	315	4	200	116	5,5	120	36
141263	350/400	4	200	93	8,5	137	30
148234	500/630	4	220	125	8,5	140	45
146013	250	4	180	113	8	103	36
147860	315	4	250	166	5,5	120	36
149974	350/400	4	260	153	8,5	137	30
148235	500/630	4	280	185	8,5	140	45

Jaws ZG-ZS

Tool group A09
Type 302 **Top jaw AB,**
special height, soft, 16MnCr5
DIN 6350

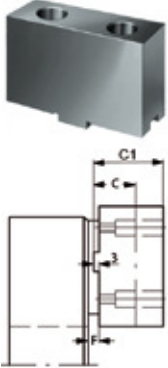

Item no.	Chuck Size	Number of jaws	C1	C	F
132155	200	3	60	43	6,8
119645	250	3	70	53	8
110435	315	3	80	58	5,5
126385	350/400	3	90	65	8,5
128590	500/630	3	100	80	8,5
128564	200	3	80	43	6,8
128571	250	3	100	53	8
110437	315	3	110	58	5,5
110628	350/400	3	120	65	8,5
110630	500/630	3	130	80	8,5
128573	250	3	150	53	8
128569	315	3	150	58	5,5
128567	350/400	3	160	65	8,5
128588	500/630	3	160	80	8,5

Tool group A09
Type 402 **Top jaw AB,**
special height, soft, 16MnCr5
DIN 6350

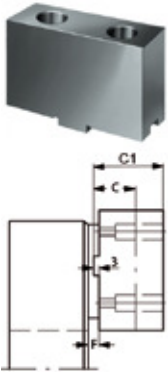

Item no.	Chuck Size	Number of jaws	C1	C	F
132181	200	4	60	43	6,8
135867	250	4	70	53	8
149975	315	4	80	58	5,5
118373	350/400	4	90	65	8,5
149985	500/630	4	100	80	8,5
149976	200	4	80	43	6,8
134999	250	4	100	53	8
129691	315	4	110	58	5,5
135426	350/400	4	120	65	8,5
149977	500/630	4	130	80	8,5
149978	250	4	150	53	8
141671	315	4	150	58	5,5
139591	350/400	4	160	65	8,5
140427	500/630	4	160	80	8,5

Tool group A09
Type 302 **Top jaw AB,**
special width and height, soft,
16MnCr5, DIN 6350

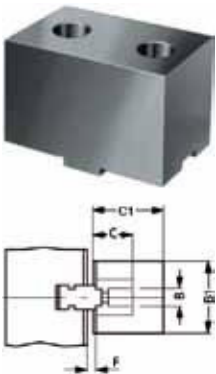

Item no.	Chuck Size	Number of jaws	B1	C1	B	C
105057	200	3	40	70	30,5	43
137090	250	3	50	80	36,5	53
143053	315	3	60	90	42	58
131567	350/400	3	60	90	42,5	65
137084	500/630	3	80	110	50,5	80
133259	200	3	50	80	30,5	43
133653	250	3	60	90	36,5	53
143057	315	3	80	110	42	58
137086	350/400	3	80	110	42,5	65

Jaws ZG-ZS

Tool group A09
Type 402 **Top jaw AB**,
special width and height, soft,
16MnCr5, DIN 6350

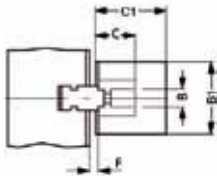

Item no.	Chuck Size	Number of jaws	B1	C1	B	C
105061 ■	200	4	40	70	30,5	43
141338 ■	250	4	50	80	36,5	53
149979 ■	315	4	60	90	42	58
149980 ■	350/400	4	60	90	42,5	65
149981 ■	500/630	4	80	110	50,5	80
149982 ■	200	4	50	80	30,5	43
137526 ■	250	4	60	90	36,5	53
149983 ■	315	4	80	110	42	58
149984 ■	350/400	4	80	110	42,5	65

Tool group C15
Type 0040-Y
**Mounting bolt for top jaws
bolt 1**



Item no.	Size	Thread
249299 ●	100/110	M6x20
236949 ●	125	M8x25
334571 ●	140/160/200	M8x30
233025 ●	250	M10x35
233026 ●	315	M12x45
220565 ●	350/400	M16x50
249003 ●	500/630	M20x80

Tool group C15
Type 0040-Y
**Mounting bolt for top jaws
bolt 2**



Item no.	Size	Thread
216528 ●	100/110	M6x16
233058 ●	125/140/160/200	M8x20
227692 ●	250	M12x25
233030 ●	315	M12x30
220564 ●	350/400	M16x35
233047 ●	500/630	M20x40